







IN-A

Price List September 2024

OISIDE



IN-A COLLECTION	Reference	Description	Dimensions (piece / cm)	Weight (kg)	Pieces (/ Box)	Dimensions (Box / cm)	Volume (m ³)	Weight (kg)	Price (€)
	133969	Worktop	120 x 80 x 108	-	1	120 x 80 x 108	-	-	9.120
	133967	Sink L	120 x 80 x 108	-	1	120 x 80 x 108	-	-	11.230
	133968	Sink R							
	133965	Teppanyaki L	120 x 80 x 108	-	1	120 x 80 x 108	-	-	10.670
	133966	Teppanyaki R							
	133963	Barbacue L	120 x 80 x 108	-	1	120 x 80 x 108	-	-	10.100
	133964	Barbacue R							
	133961	Ceramic Stove L	120 x 80 x 108	-	1	120 x 80 x 108	-	-	10.260
	133962	Ceramic Stove R							
	133951	Counter	120 x 80 x 108	-	1	120 x 80 x 108	-	-	3.225
	133952	Under Counter Grill	120 x 80 x 100	-	1	120 x 80 x 100	-	-	9.720

MATERIALS AND FINISHES

STRUCTURE

ALUMINUM



RAL 3012



RAL 6003



RAL 7044

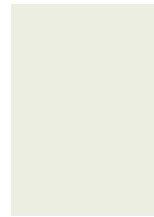

RAL 9002



RAL 9005



RAL 7021

TOP

DEKTON



Aura



Avorio

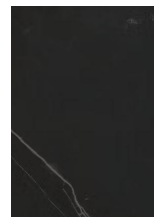

Kelya



Grafite



Umber

INALCO



Meteora



Petra

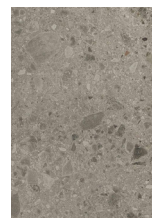

Iseo



Alea

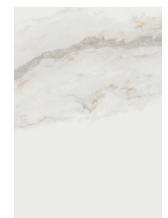

Larsen

ALUMINUM



RAL 3012



RAL 6003



RAL 7044

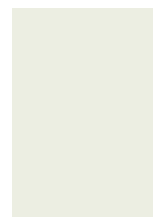

RAL 9002



RAL 9005



RAL 7021

Barbacue



Barbecue with electric element.

Lava stone included.

Settings 0 to 9.

Maximum absorbed power: 2,4kW.

Equipment: Schuko mains plug.

Waterproof Cover.

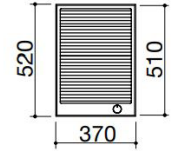
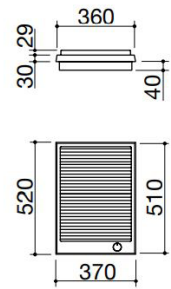

Waterproof cover.

Teppanyaki



2 cooking area.

Electronic temperature control 0 °C to 250 °C.

Hotplate activation indicator and thermostat.

Maximum absorbed power: 3kW.

Equipment: Schuko mains plug.

Waterproof cover.

Thalas chopping board.

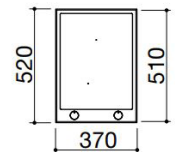
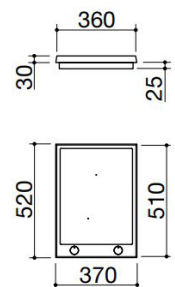

Solid oak wood Thalas chopping board.



Waterproof cover.

Sink



54x34x18,3 cm Bowl.

Balanced, removable, AISI 316 stainless steel Cover with manual opening.

Equipment: 3" 1/2 basket strainer waste, B overflow, Thalas telescopic mixer tap with remote control.

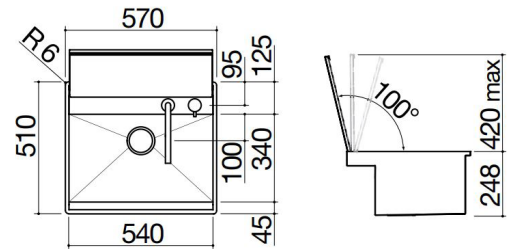

Charcoal Grill



Color: Black and steel

Made of stainless steel (AISI 304) and aluminium

6 mm heavy-duty stainless-steel grid

Patented insert

Designed and manufactured in Denmark

Height 49 cm, width 55 cm/45 cm

Kettle barbecue: Diameter 45 cm

Cooking area: Diameter 40 cm

Weight: 7,5 kg

Ceramic Stove

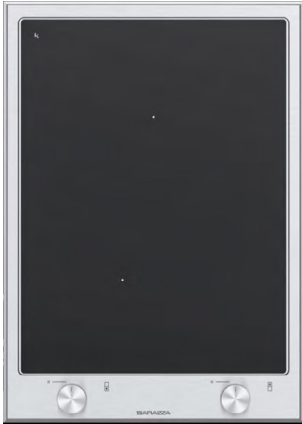

Induction Plaque.

Minimum pan diameter: $\varnothing 90$ mm.

Ajustable power levels: 1,6 - 2,0 - 2,4 - 2,8 - 3,2 - 3,7 kW.

Maximum absorbed power: 3,7kW.

Equipment: Schuko mains plug.

Waterproof Cover.

Thalas chopping board.

Functions: power management, booster, selective pan detection, keep warm, automatic preheating, electronic chilsafety lock, residual heat indicator, safety switch-off.

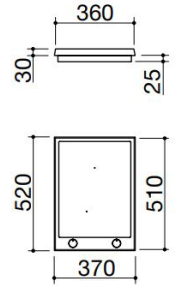

Solid oak wood Thalass chopping board.



Waterproof cover.

Multi-purpose cover



Extra thick AISI 316 stainless steel.

Dual function: cover and serving tray.

Compatible with all kitchen modules.

Compatible with waterproof.

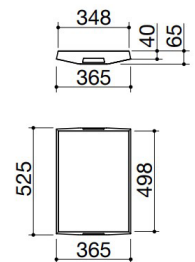



Patio Exterior SL. Polígono Industrial El Saladar
C/ La Morera, 13. 30850 Totana, Murcia. Spain.
968 41 80 83 / oiside@oiside.com